

ROBOR GROOVE-ENDED FORGED STEEL COUPLINGS

ROBOR shoulder-ended forged steel couplings conform to SANS 815-2.

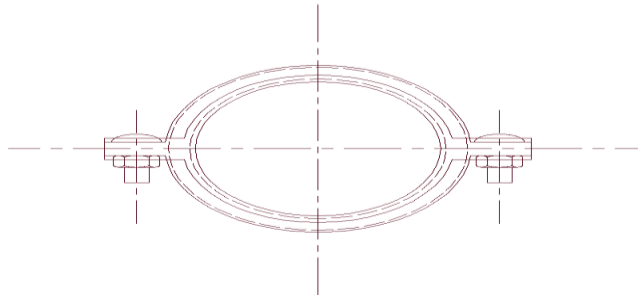

Nominal Size mm	Pipe Minimum Wall Thickness mm	Outside Diameter of Pipe Max mm	Maximum Hydraulic Working Pressure of Coupling in Groove-ended Joint Bar	Maximum Hydraulic Working Pressure of Coupling in Cut Groove-ended Joint Bar	Bolt & Nut Sizes
50	1.6	60.3	20	35	M10
50	2.6	60.3	25	35	M10
50	3.2	60.3	25	35	M10
50	3.9	60.3	25	35	M10
80	2.0	88.9	20	30	M10
80	3.0	88.9	20	30	M10
80	3.5	88.9	20	30	M10
80	4.2	88.9	20	30	M10
100	2.0	114.3	20	30	M12
100	3.3	114.3	20	30	M12
100	3.9	114.3	25	30	M12
100	4.7	114.3	25	30	M12
150	2.8	165.1	20	25	M12
150	3.3	165.1	20	25	M12
150	4.2	165.1	20	25	M12
150	4.7	165.1	20	31	M12
200	3.3	219.1	17	20	M16
200	4.2	219.1	17	20	M16
200	5.5	219.1	17	25	M16
250	4.2	273.0	12	17	M20
250	5.5	273.0	12	17	M20
300	4.2	323.9	12	12	M20
300	5.5	323.9	12	12	M20

Coupling Housing	Special profile to RYC460 derived from SANS 1431 450WA
Bolts & Nuts	ISO 898-1, Grade 8.8, electroplated or hot-dipped galvanised to ISO 1461
Gaskets	SANS 974-1, EPDM
Coating	Painted or hot-dipped galvanised to ISO 1461