

ROBOR SHOULDER-ENDED FORGED STEEL COUPLINGS

ROBOR shoulder-ended forged steel couplings conform to SANS 815-1.

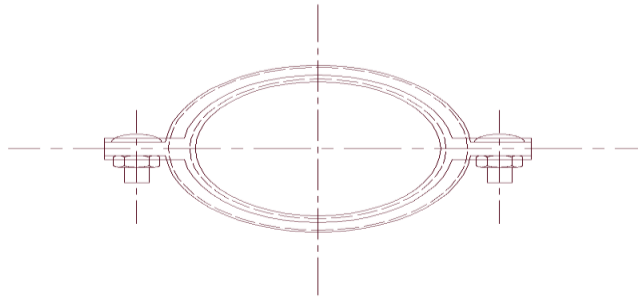

Nominal Size mm	Pipe Minimum Wall Thickness mm	Outside Diameter of Pipe Max mm	Maximum Hydraulic Working Pressure of Coupling in Ring-ended Joint Bar	Maximum Hydraulic Working Pressure of Coupling in Stub-ended Joint Bar	Bolt & Nut Sizes	Maximum Deflection from Centre Line per Coupling	Maximum Deflection from Centre Line per 6m Pipe mm
48	1.6	48.5	20	25	M10	1°56'	202
50	1.6	60.3	20	25	M10	2°34'	269
50	2.6	60.3	20	25	M10	2°34'	269
50	3.2	60.3	20	30	M10	2°34'	269
50	3.9	60.3	20	40	M10	2°34'	269
80	2.0	88.9	20	25	M10	1°46'	186
80	3.0	88.9	20	25	M10	1°56'	186
80	3.5	88.9	20	30	M10	1°56'	186
80	4.2	88.9	20	40	M10	1°56'	186
100	2.0	114.3	20	25	M12	2°48'	294
100	3.3	114.3	20	25	M12	2°48'	294
100	3.9	114.3	20	25	M12	2°48'	294
100	4.7	114.3	20	35	M12	2°48'	294
102	1.6	102.5	20	25	M10	1°36'	167
150	2.8	165.1	20	25	M12	1°58'	101
150	3.3	165.1	20	25	M12	1°58'	101
150	4.2	165.1	20	25	M12	1°58'	101
150	4.7	165.1	20	35	M12	1°58'	101
152	2.8	153.2	20	25	M12	0°42'	74
200	3.3	219.1	17	20	M16	0°44'	78
200	4.2	219.1	17	20	M16	0°44'	78
200	5.5	219.1	17	30	M16	0°44'	78
250	4.2	273.0	16	-	M20	0°36'	63
250	5.5	273.0	16	-	M20	0°36'	63
300	4.2	323.9	15	-	M20	0°30'	54
300	5.5	323.9	15	-	M20	0°30'	54

Coupling Housing	Special profile to RYC460 derived from SANS 1431 450WA
Bolts & Nuts	ISO 898-1, Grade 8.8, electroplated or hot-dipped galvanised to ISO 1461
Gaskets	SANS 974-1, SBR or NBR
Coating	Painted or hot-dipped galvanised to ISO 1461